

Burning and soldering tips are consumables, and it is possible to replace them with tips available on 3Dsimo e-shop. Dismount the tip by unscrewing it counterclockwise. Tightening of replacement tip has to be done clockwise, finger tight only, without using any tools.

Foam cutting attachment

Cleaning of the resistance wire can be done using paper towels.

In case of resistance wire breaking, always replace the wire with new segment from supplied spool, or with wire available at 3Dsimo e-shop.

7. WARNING

Danger of burn injury – 3Dsimo attachments and it's parts can reach temperature of up to 450°C (842°F), DO NOT TOUCH the nozzle, resistance wire or the burning and soldering tips few minutes after finishing work with the attachment.

DO NOT dismount the 3D drawing attachment when the filament is still inside the attachment, otherwise you might damage internals of the device!

Avoid contact of 3Dsimo MultiPro and it's parts with flammable and volatile substances. Warn your surroundings about high temperatures of attachments. Always let the attachments cool off before storing them in the packaging, otherwise high temperatures may lead to damage to the packaging and attachments.

Always use original 3Dsimo Inc. filaments and accessories. Using unauthorised filaments and accessories may lead to unrepairable damage to the device and it's attachments. 3Dsimo Inc. is not liable for damage caused by not following User's manual.

This product and any of it's parts are not a toy, children have to be under adult supervision while using this device.

Keep all the parts and accessories of 3Dsimo MultiPro dry, avoid contact with fluids at any times while transporting and/or storing 3Dsimo device.

Never take 3Dsimo MultiPro apart. In case of any failure or unwanted behavior, contact our customer support: support@3dsimo.com

Never use power adapter and power cable if any of it's parts are damaged. Risk of injury by electricity.

Save this User's manual for later use.

3Dsimo Inc. is not responsible for any injury or damage to property if 3Dsimo MultiPro or any of it's accessories and attachments are used otherwise than is stated in this user's manual.

8. SPECIFICATIONS

Adapter:

Input voltage: 100–240 V AC, 50 / 60 Hz
Output voltage: 12 V
Output power: 24 W

3Dsimo MultiPro:

Input voltage: 12–24 V
Input current: 2 A

Noise level:

21–30 dB

9. CERTIFICATES

This device follows European Regulation for Registration, Evaluation, Authorisation and Restriction of Chemicals (REACH) (Regulation no.: 1907/2006/ES of European parliament and European Council), and European regulation for limiting usage of dangerous substances in electronic devices (ROHS) (Regulation no.: 2002/95/ES of European parliament and European Council) European safety regulations. This device is following European safety regulations.

10. WARRANTY AND CUSTOMER SUPPORT

This device includes 12 month warranty.

In case of any failure or misbehavior of this device, please contact: support@3dsimo.com

Original accessories and filaments are available here: eshop.3dsimo.com



MultiPro

INSTRUCTION FOR USE – 3DSIMO MULTIPRO:

Multifunctional tool for workshops and households



1. INTRODUCTION

Congratulations on your purchase of 3Dsimo MultiPro, multifunctional tool, which will help you transform your creativity into reality. All you need to do, is power up the 3Dsimo MultiPro using included adapter, chose attachment, mount the attachment and finish tutorial displayed on the device.

Before you start using the device, make sure you are familiar with this user's manual and all the functions, maintenance and risks of using 3Dsimo MultiPro.

In case of any questions, please visit our website or contact our customer support: support@3dsimo.com

2. PACKAGE CONTENT

- 1x 3Dsimo MultiPro with 3D drawing attachment mounted
- 1x Soldering attachment
- 1x Burning attachment
- 1x Foam cutting attachment
- 1x Platform for accurate foam cutting
- 1x Platform bolt
- 1x Power adapter
- 1x Spool of resistance wire
- 1x Package of soldering tin
- 15 meters of filament

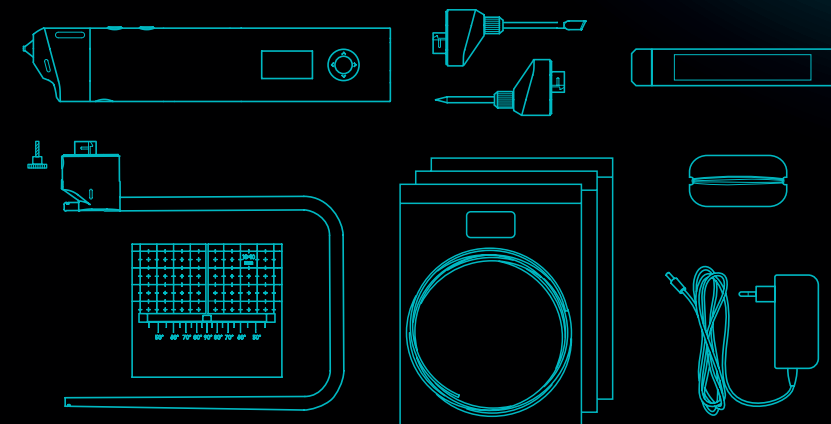

3. 3DSIMO MULTIPRO CONTROLS

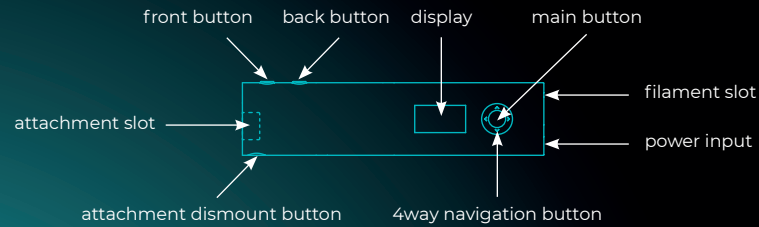

4. SMARTPHONE APP

Smartphone app is available for Android and iOS devices. (3Dsimo App will be available 1. 2. 2019)

3Dsimo App allows you to update your device for future attachments, also offers a number of tutorials and ideas on usage of your 3Dsimo MultiPro.

3Dsimo MultiPro connectivity is available via Bluetooth.

3D drawing attachment

After mounting the 3D drawing attachment and successful completion of tutorial, choose correct filament type. Material profile can be changed with navigation cross, using left and right buttons. Also you can choose different feeding speeds using up and down buttons. When READY is shown on the display, insert filament. When filament is inserted, it is necessary to push the filament in, while holding front button. After about 5 seconds, filament will start to come out from tip of the nozzle.

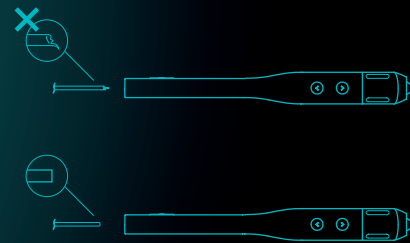

5. ATTACHMENT CHANGE

Your 3Dsimo MultiPro comes with the 3D drawing tool attached.

To dismount the attachment, press Attachment dismount button, then dismount the attachment away from the device.

To mount any attachment, insert chosen attachment into attachment slot. The attachment will be automatically recognised by the device.

If the attachment was inserted for the first time, tutorial for the specific attachment will appear on the device display.

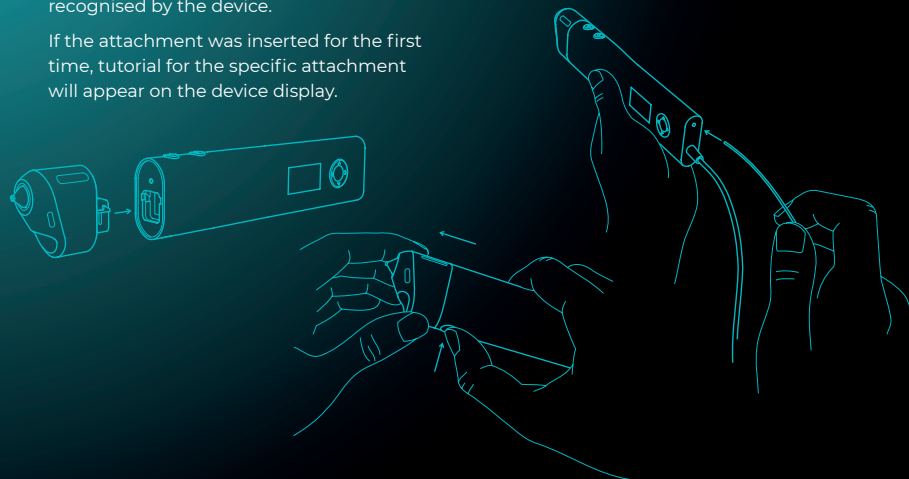

Foam cutting attachment

First, you have to tighten the cutting wire between both ends of the attachment (see picture), mount the attachment to the 3Dsimo MultiPro, choose desired temperature of the tip (0-100%) and activate heating of the attachment by pressing front button.

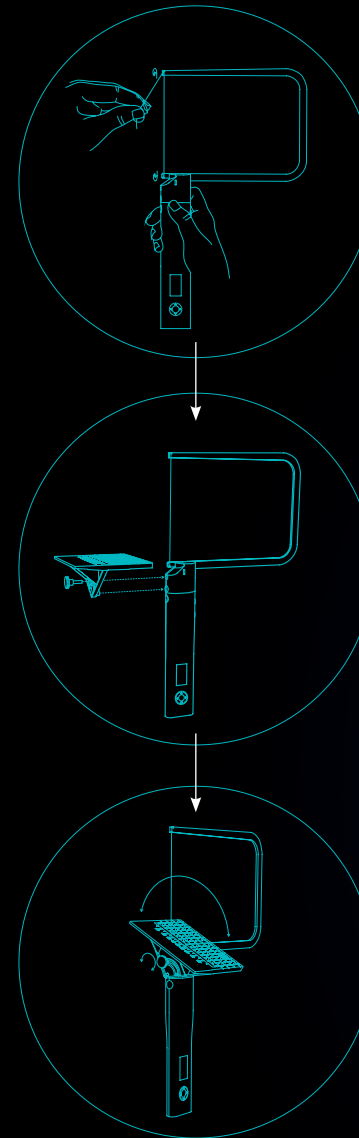

Burning attachment

After mounting the Burning attachment and successful completion of tutorial, choose desired temperature of the tip (0-100%; 100% \approx 450°C / 842°F) and activate heating of the attachment by pressing front button.

Soldering attachment

After mounting the Soldering attachment and successful completion of tutorial, choose desired temperature of the tip (0-100%; 100% \approx 450°C / 842°F) and activate heating of the attachment by pressing front button.

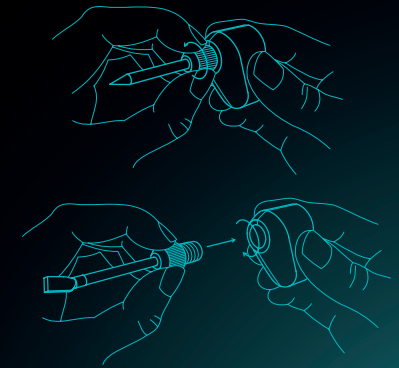

6. MAINTENANCE

3D drawing attachment

Make sure the filament is not deformed and wound up too tightly.

Before finishing your work with 3D drawing attachment, **ALWAYS** fully pull out the filament, to prevent possible damage to internal parts of your device.

Cleaning the nozzle is possible using paper towels when the nozzle is heated up to operating temperature – **WARNING – HOT!**

Soldering and Burning attachment

Cleaning the attachment is possible using paper towels, never use sharp, hard or otherwise abrasive tools, tips have special coating and such cleaning methods may lead to unwanted behavior of the attachment.